



乐清市乐宇自动化电气有限公司

Yueqing Leyu Electric Automation Co., Ltd.

30W Single Output Industrial DIN Rail Power Supply

DR-30 series

Features:

Universal AC input/ full range

Protections: Short circuit/ Over load/ Over voltage

Cooling by free air convection

Can be installed on DIN rail TS-35/7.5 or 15

Isolation class II

LED indicator for power on

100% full load burn-in test

1 year warranty

SPECIFICATIONS

OUTPUT				
Model	DR-30-5	DR-30-12	DR-30-15	DR-30-24
DC Voltage	5V	12V	15V	24V
Rated Current	3A	2A	2A	1.5A
Current Range	0-3A	0-2A	0-2A	0-1.5A
Rated Power	15W	24W	30W	36W
Ripple & Noise	80mVp-p	120mVp-p	120mVp-p	150mVp-p
Voltage Adj. Range	-5%,+10%	±10%	±10%	±10%
Voltage Tolerance	±2%	±1%	±1%	±1%
Setup, Rise, Hold Up Time	100ms,30ms/230VAC 100ms,30ms/115VAC at full load			
INPUT				
Voltage Range	85~264VAC 47~63Hz; 120~370VDC			
AC Current	0.88A/115V 0.48A/230V			
Efficiency	74%	81%	82%	83%
Inrush Current	Cold start 15A/115V 30A/230V			
PROTECTION				
	105%~160%			
Over Load	Protection type: Constant current limiting, recovers automatically after fault condition is removed			
	115%~135%			
Over Voltage	Protection type: Shut down o/p voltage, re-power on to recover			
ENVIRONMENT				
Working Temp.,	-10°C~+60°C; 20%~90%RH			



乐清市乐宇自动化电气有限公司
Yueqing Leyu Electric Automation Co., Ltd.

Humidity	
Storage Temp., Humidity	-40°C~+85°C; 10%~95%RH
Temp. Coefficient	±0.03%/°C(0~50°C)
Vibration	10~500Hz, 2G 10min./1cycle, period for 60min, each along X, Y, Z axes
SAFETY	
Withstand Voltage	I/P-O/P: 3KVAC
Isolation Resistance	I/P-O/P: 100M Ohms / 500VDC
STANDARD	
Safety Standard	Design refer to UL60950-1,TUV EN60950-1,EN50178
EMC Standard	Design refer to EN55011,EN55022,EN61000-3-2,-3,EN61000-4-2,3,4,5,6,8,11,ENV50204,EN55024,EN61000-6-2,EN61204-3
OTHERS	
Dimension	78*93*56mm(L*W*H)
Weight	0.27Kg
Packing	48pcs/14Kg/1.02CUFT
NOTE	
1.All parameters NOT specially mentioned are measured at 230VAC input, rated load and 25°C of ambient temperature.	
2. Ripple & noise are measured at 20MHz of bandwidth by using a 12" twisted pair-wire terminated with a 0.1μ & 47μ parallel capacitor.	
3.Tolerance: includes set up tolerance, line regulation and load regulation.	
4.The power supply is considered a component which will be installed into a final equipment. The final equipment must be re-confirmed that it still meets EMC directives.	



®

乐清市乐宇自动化电气有限公司

Yueqing Leyu Electric Automation Co., Ltd.



30W Single Output Industrial DIN Rail Power Supply

DR-30 Series

■ Outline and Dimension:

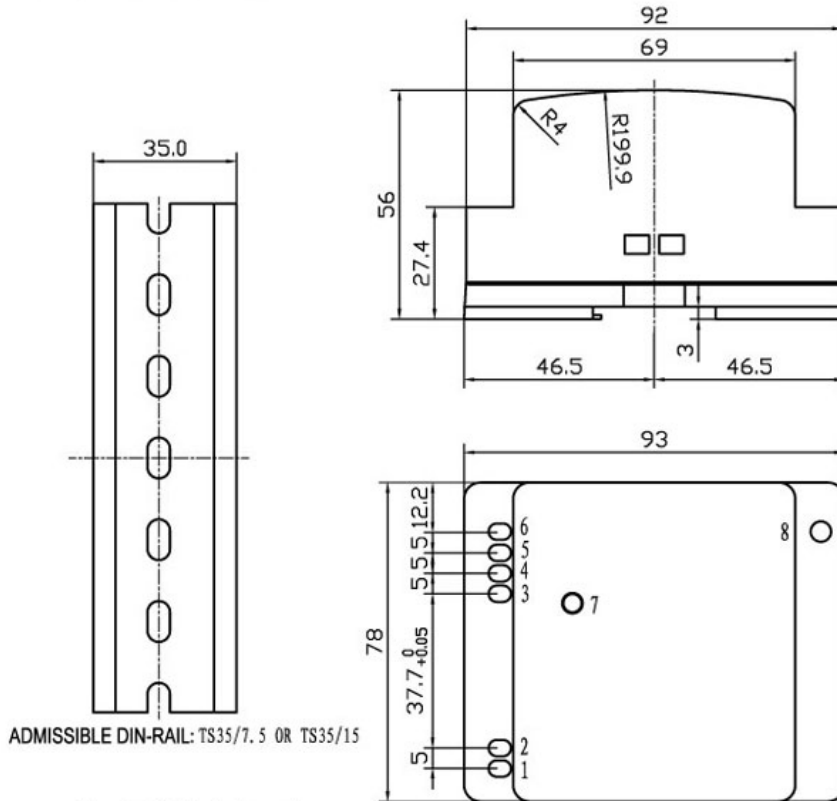

Terminal Pin No. Assignment:

Pin No.	Assignment	Pin No.	Assignment
1	AC/N	5, 6	-V
2	AC/L	7	LED
3, 4	+V	8	+V ADJ.

■ Output Derating

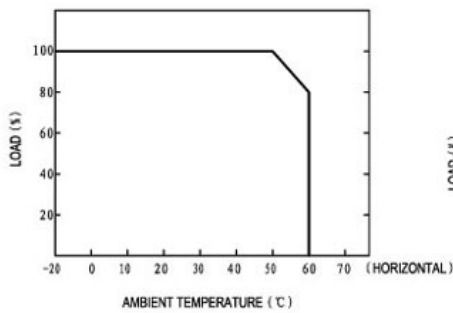

■ Output Derating VS Input Voltage

